



Sonic KB

Sonic



Features

- Sheathing made of soft rubber to reduce sound bridges
- Weather-resistant - ideal for indoor and outdoor use
- High holding values
- Anchor core made of hard plastic

Sonic

- Pre-positioned and push-through installation

Sonic KB

- Sound decoupling for attached fixtures

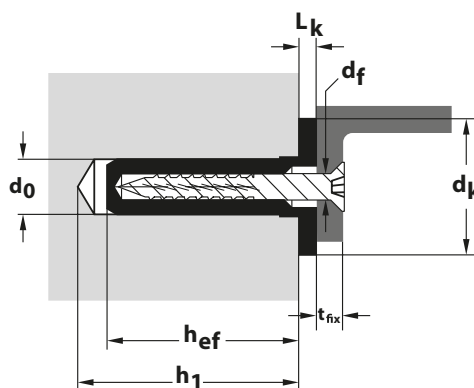

Pack	Item No.	Type	Content anchor	Plug \varnothing	Plug length	Screw \varnothing	Drill \varnothing	Effective anchorage depth	Drill hole depth	Approval
	Sonic per pack			d \varnothing mm	mm	\varnothing mm	d \varnothing mm	hef mm	h1 \geq mm	ETA
	018 100 101	10/30	100x	10	30	4,0-5,0	10	30	40	-
	018 100 121	12/40	100x	12	40	5,0-6,0	12	40	50	-
	018 100 141	14/50	50x	14	50	6,0-8,0	14	50	60	-
	018 100 161	16/60	50x	16	60	8,0-10,0	16	60	75	-

Pack	Item No.	Type	Content anchor	Plug \varnothing	Plug length	Screw \varnothing	Collar \varnothing	Collar height mm	Drill \varnothing	Effective anchorage depth	Drill hole depth	Approval
	Sonic KB per pack			d \varnothing mm	mm	\varnothing mm	dk	Lk	d \varnothing mm	hef mm	h1 \geq mm	ETA
	018 100 102	10/30	100x	10	30	4,0-5,0	22	4	10	30	40	-
	018 100 122	12/40	100x	12	40	5,0-6,0	30	4	12	40	50	-
	018 100 142	14/50	50x	14	50	6,0-8,0	34	5	14	50	60	-
	018 100 162	16/60	50x	16	60	8,0-10,0	42	6	16	60	75	-

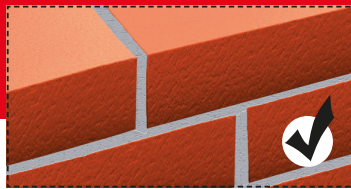

Sonic & Sonic KB	Concrete C 20/25	Solid brick MZ12	Perforated sand-lime brick ≥ KSL12
10/30	20 kg	15 kg	10 kg
12/40	30 kg	25 kg	20 kg
14/50	50 kg	40 kg	30 kg
16/60	80 kg	70 kg	50 kg

- Approved plugs must be used for fixings where safety is of importance (see also www.tox.de/safety+loads)
- The specified holding values refer to screws with the largest screw diameter; thread shape similar to DIN 7998
- The anchoring depth of the plug must be observed
- Drilling method and drill hole cleaning must be adapted to the building material
- The recommended loads only apply to installation in the building material, not for installation in joints

Description & Area of Application

Sonic :

- For substructures and sound-insulating constructions
- Anchors for sound insulation in drywall and timber construction or in building services engineering
- No additional decoupling elements required
- Ideal for indoor and outdoor use with high holding values in concrete, solid brick, lightweight concrete, and sand-lime brick
- For fixing e.g. cable and pipe clamps, wall brackets for heating and air conditioning units, substructures, handrails or stair treads









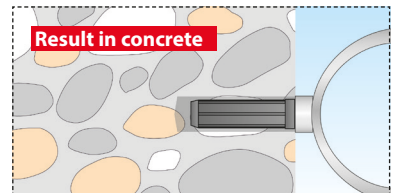
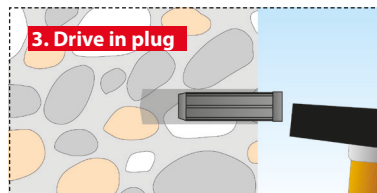
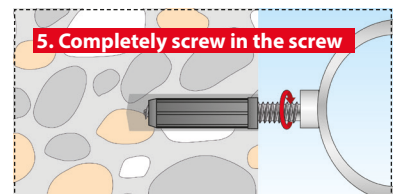
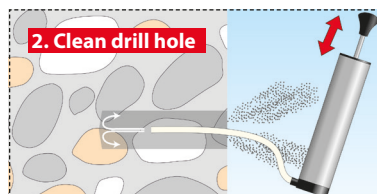
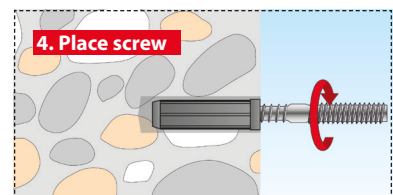
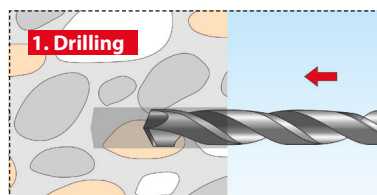

Processing & Installation

Sonic:

- Drill hole
- Clean drill hole
- Drive in plug
- Screw in the screw
- Pre-positioned or push-through installation



Item No.	Item	EAN code
018 100 101	Sonic 10/30	 4 049563 059663
018 100 102	Sonic KB 10/30	 4 049563 059700
018 100 121	Sonic 12/40	 4 049563 059670
018 100 122	Sonic KB 12/40	 4 049563 059717
018 100 141	Sonic 14/50	 4 049563 059687
018 100 142	Sonic KB 14/50	 4 049563 059724
018 100 161	Sonic 16/60	 4 049563 059694
018 100 162	Sonic KB 16/60	 4 049563 059731