

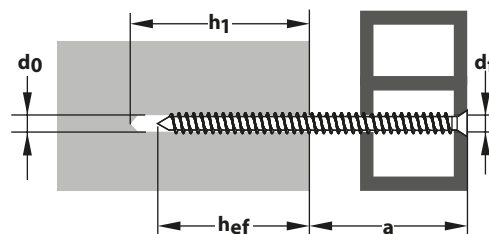



## Features

- Installation without additional plug
- Tension-free stand-off installation due to thread engagement in the frame and building material
- Quick installation due to small drill diameter
- Easy screwing in
- Optimized thread
- Applicable in concrete, solid brick, perforated brick and wood



| Pack  | Item No.      | Type    | Content screw | Content cover cap | Screw $\varnothing$ | Screw length | Drive   | Drill $\varnothing$             | Min. drill hole depth | Effective anchorage depth | Spacing building material | Approval |
|---|---------------|---------|---------------|-------------------|---------------------|--------------|---|---------------------------------|-----------------------|---------------------------|---------------------------|----------|
|  | Window Pro FK |         | per pack      | per pack          | mm                  | mm           |  | $d_0 / d_f$<br>$\varnothing$ mm | $h_1$<br>$\geq$ mm    | $hef$<br>$\geq$ mm        | $a$<br>$\leq$ mm          | ETA      |
|   | 092 101 53    | 7,5/72  | 100x          | -                 | 7,5                 | 72           | TX 30   | 6,0 / 6,5                       | 40 [70]               | 30 [60]                   | 42 [12]                   | -        |
|   | 092 101 55    | 7,5/92  | 100x          | -                 | 7,5                 | 92           | TX 30   | 6,0 / 6,5                       | 40 [70]               | 30 [60]                   | 62 [32]                   | -        |
|   | 092 101 57    | 7,5/112 | 100x          | -                 | 7,5                 | 112          | TX 30   | 6,0 / 6,5                       | 40 [70]               | 30 [60]                   | 82 [52]                   | -        |
|   | 092 101 59    | 7,5/132 | 100x          | -                 | 7,5                 | 132          | TX 30   | 6,0 / 6,5                       | 40 [70]               | 30 [60]                   | 102 [72]                  | -        |
|   | 092 101 61    | 7,5/152 | 100x          | -                 | 7,5                 | 152          | TX 30   | 6,0 / 6,5                       | 40 [70]               | 30 [60]                   | 122 [92]                  | -        |
|   | 092 101 63    | 7,5/182 | 100x          | -                 | 7,5                 | 182          | TX 30   | 6,0 / 6,5                       | 40 [70]               | 30 [60]                   | 152 [122]                 | -        |
| 092 101 65  | 7,5/212       | 100x    | -             | 7,5               | 212                 | TX 30        | 6,0 / 6,5   | 40 [70]                         | 30 [60]               | 182 [152]                 | -                         |          |

## Building materials & Holding values



| Window Pro           | Concrete<br>C 20/25 | Solid brick<br>MZ 12 | Vertically perforated<br>brick $\geq$ Hlz12<br>Bulk density 1 kg/dm <sup>3</sup> | Hollow brick<br>$\geq$ Hbl2 | Aerated concrete<br>$\geq$ PB2, PP2 | Wood |
|----------------------|---------------------|----------------------|--|-----------------------------|-------------------------------------|------|
| $\varnothing$ 7,5 mm | 150 kg*             | 70 kg*               | 10 kg*   | 10 kg*                      | 10 kg*                              | -    |

- The anchoring depth of the plug must be observed
- Drilling method and drill hole cleaning must be adapted to the building material
- The recommended loads only apply to installation in the building material, not for installation in joints
- Approved plugs must be used for fixings where safety is of importance (see also [www.tox.de/safety+loads](http://www.tox.de/safety+loads))

\*Holding value applies to tensile and shear force

## Description & Area of Application

### Window Pro FK:

- Made of case-hardened steel with self-tapping thread and flat head with TX drive
- Suitable for tension-free stand-off installations of windows, doors and squared timber

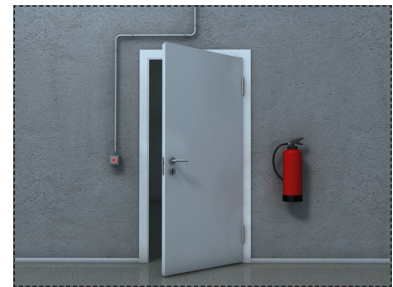

## Processing & Installation

- Observe drill hole  $\varnothing$ , screw-in depth and drill hole depth of the various building materials
- For hollow masonry, the frame screw length must be selected so that the screw-in depth passes at least through one internal web
- Push-through installation

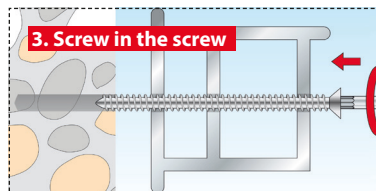
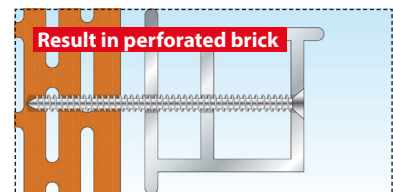
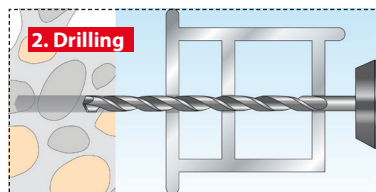
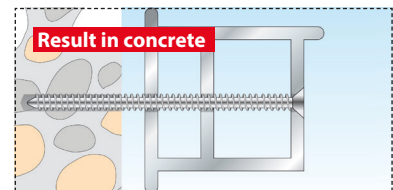
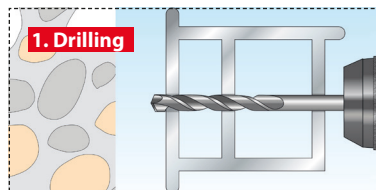

| Item No.   | Item                  | EAN code        |
|------------|-----------------------|-----------------|
| 092 101 53 | Window Pro FK 7,5/72  | 4 049563 054248 |
| 092 101 55 | Window Pro FK 7,5/92  | 4 049563 054255 |
| 092 101 57 | Window Pro FK 7,5/112 | 4 049563 054262 |
| 092 101 59 | Window Pro FK 7,5/132 | 4 049563 054279 |
| 092 101 61 | Window Pro FK 7,5/152 | 4 049563 054286 |
| 092 101 63 | Window Pro FK 7,5/182 | 4 049563 054293 |
| 092 101 65 | Window Pro FK 7,5/212 | 4 049563 054309 |